

Type 4003

Possible combinations

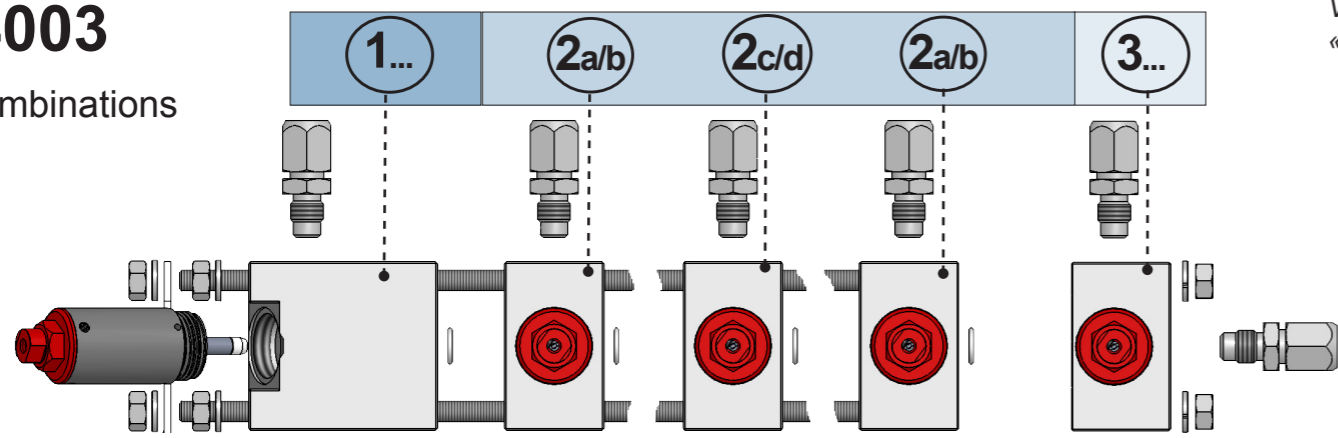

Valves and couplings :
«POMTAVA accessories» catalog

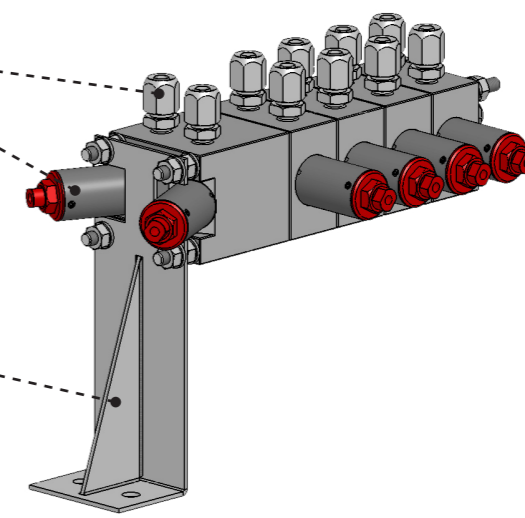

90° mounting element :
Please consult us

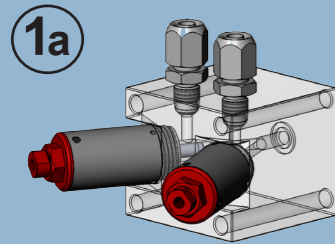

Emulsion block - without recirculation

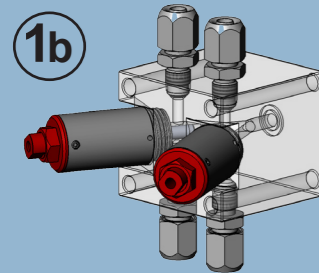

Emulsion block - with recirculation

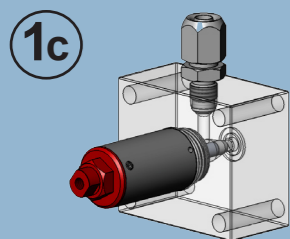

Flushing block - without recirculation

Input blocks

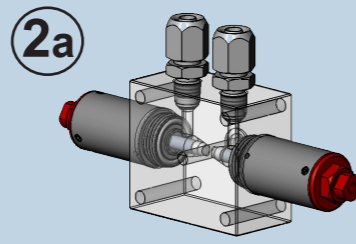

Intermediate block - without recirculation

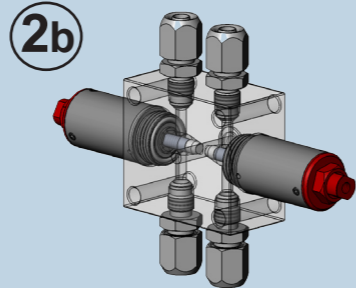

Intermediate block - with recirculation

Note : If there are more than 8 blocks, 1 the intermediate block will be threaded

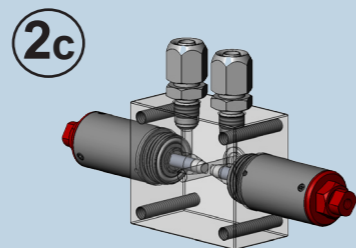

Intermediate block threaded - without recirculation

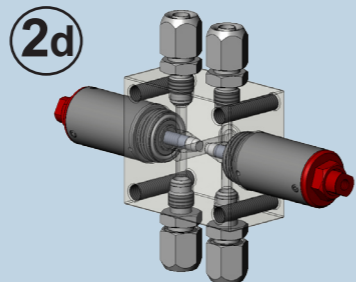

Intermediate block threaded - with recirculation

Intermediate blocks

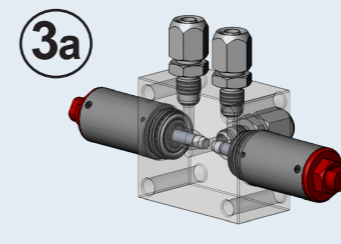

Output block - without recirculation

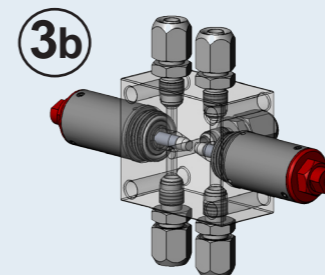

Output block - with recirculation

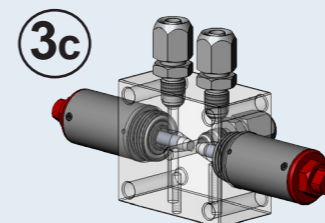

Output block - with controlled recirculation

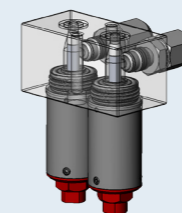

Control for recirculation

Output blocks

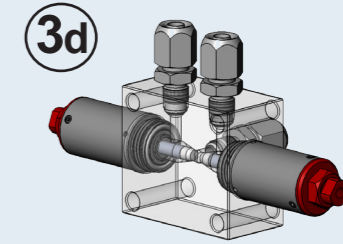

Blind output block - without recirculation

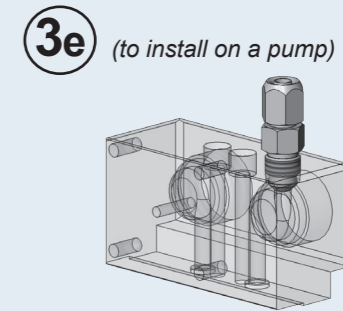

Output block RAC

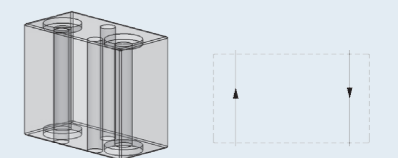
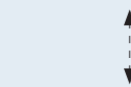

Buffer for recirculation

We have the solution to your problems !
Don't hesitate to contact us.

POMTAVA S.A. 
Nonceruz 2
CH-2732 Reconvilier

phone +41 (0)32 481 15 14
fax +41 (0)32 481 48 18
mail info@pomtava.com
net www.pomtava.com

Other configurations more custom-tailored are possible